

Decor Harmonique MD094 1200x500

Height: 1200

Width: 500

Depth: 159

Weight HO: 13.9 kg

EO: kg

Tube ϕ : 40x20 + 40x10

Face-Face Connections: 442

Elec. element if specified: 200

Output @ 50°C Δ T Watts: 842

BTUs: 2873

All dimensions in millimetres

Manufactured from Mild Steel

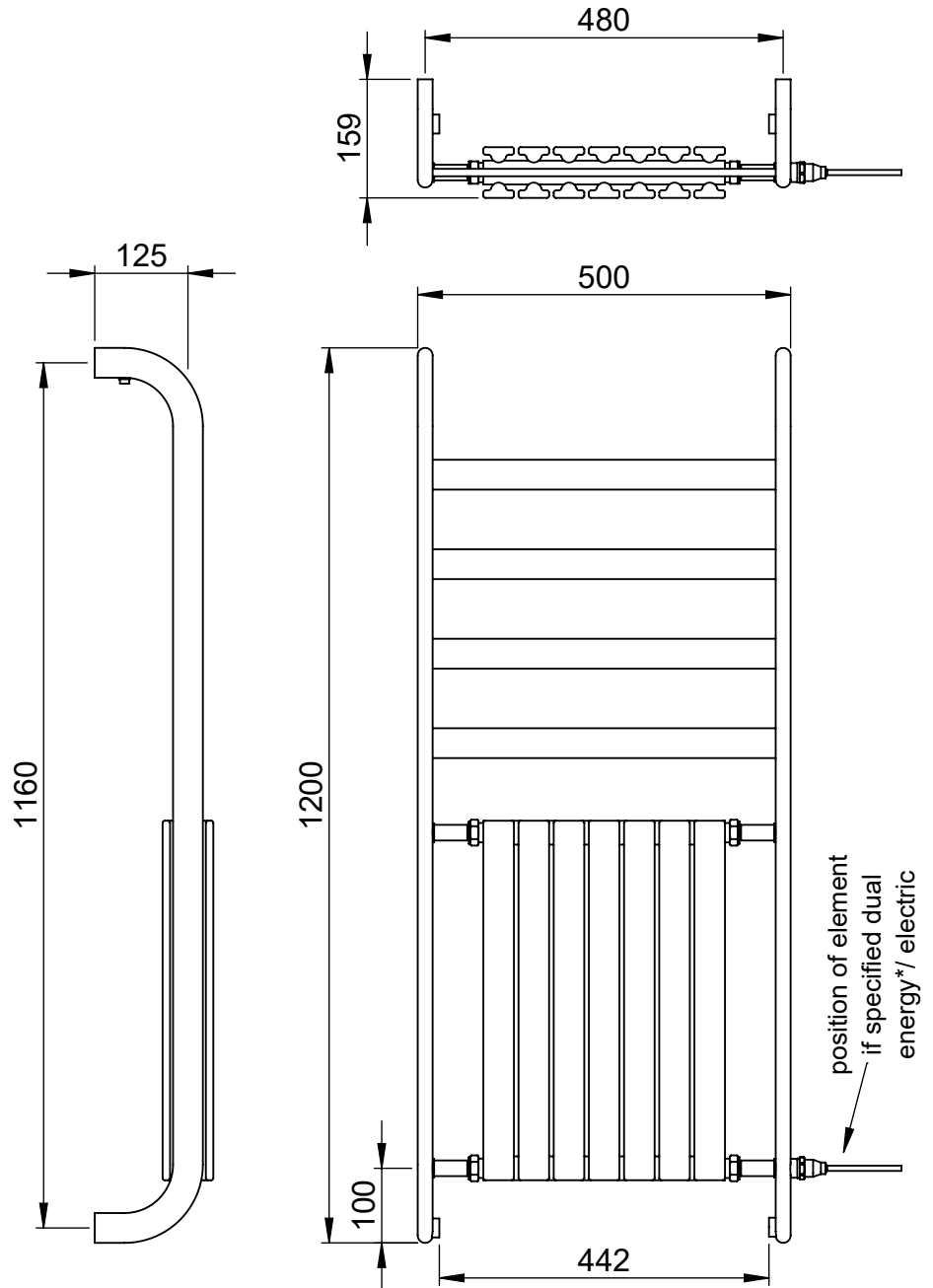
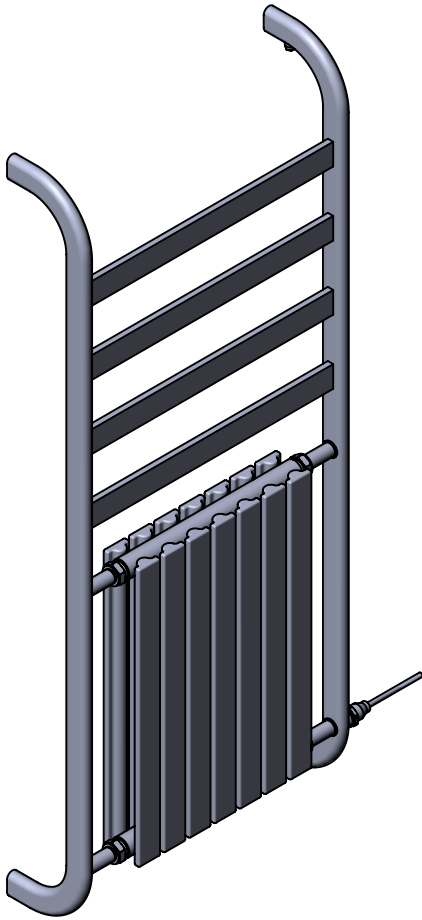

*Dual energy models require a conversion-tee, consult relevant drawing for details.

Vogue UK Ltd. reserve the right to alter specifications without prior notice.
ALL MEASUREMENTS ARE NOMINAL DIMENSIONS ONLY, AND ARE NOT BINDING.

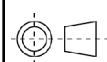

SCALE 1:10



VOGUE UK

TOWEL WARMERS & RADIATORS

Strawberry Lane, Willenhall
West Midlands WV13 3RS

Tel: 01902 387000 Fax: 01902 387001

e-mail:sales@vogueuk.co.uk www.vogueuk.co.uk